

Calculation Summary							
Label	CalcType	Units	Avg	Max	Min	Avg/Min	Max/Min
Parking Garage Floor	Illuminance	FC	12.24	81.1	1.2	8.34	103.5
Luminaire Schedule							
Symbol	Qty	Label	Arrangement	Description	LMF	Luminaire Lumens	Luminaire Watts
○	18	01E	Single	Utopia Lighting LRC-36-SLEP-40K-18W-WS (connected to	0.900	4810	87
○	18	01E	Single	GenerataLighting LRC-36-SLEP-40K-18W-WS (connected to	0.900	4810	87
○	11	01	Single	GenerataLighting LRC-36-SLEP-40K-18W-WS	0.900	4810	87

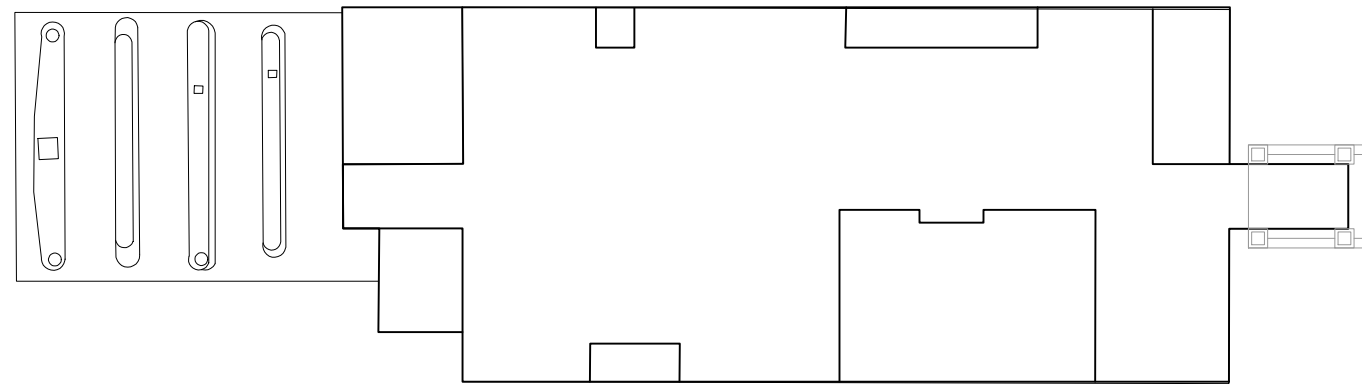

LEVEL 1.5
01
P-002
PHOTOMETRICS - NORMAL
SCALE: 1"= 30'-0"

Calculation Summary							
Label	CalcType	Units	Avg	Max	Min	Avg/Min	Max/Min
Parking Garage Floor	Illuminance	FC	12.24	81.1	1.2	8.34	103.5
Luminaire Schedule							
Symbol	Qty	Label	Arrangement	Description	LMF	Luminaire Lumens	Luminaire Watts
○	18	01E	Single	Utopia Lighting LRC-36-SLEP-40K-18W-WS (connected to	0.900	4810	87
○	18	01E	Single	GenerataLighting LRC-36-SLEP-40K-18W-WS (connected to	0.900	4810	87
○	11	01	Single	GenerataLighting LRC-36-SLEP-40K-18W-WS	0.900	4810	87

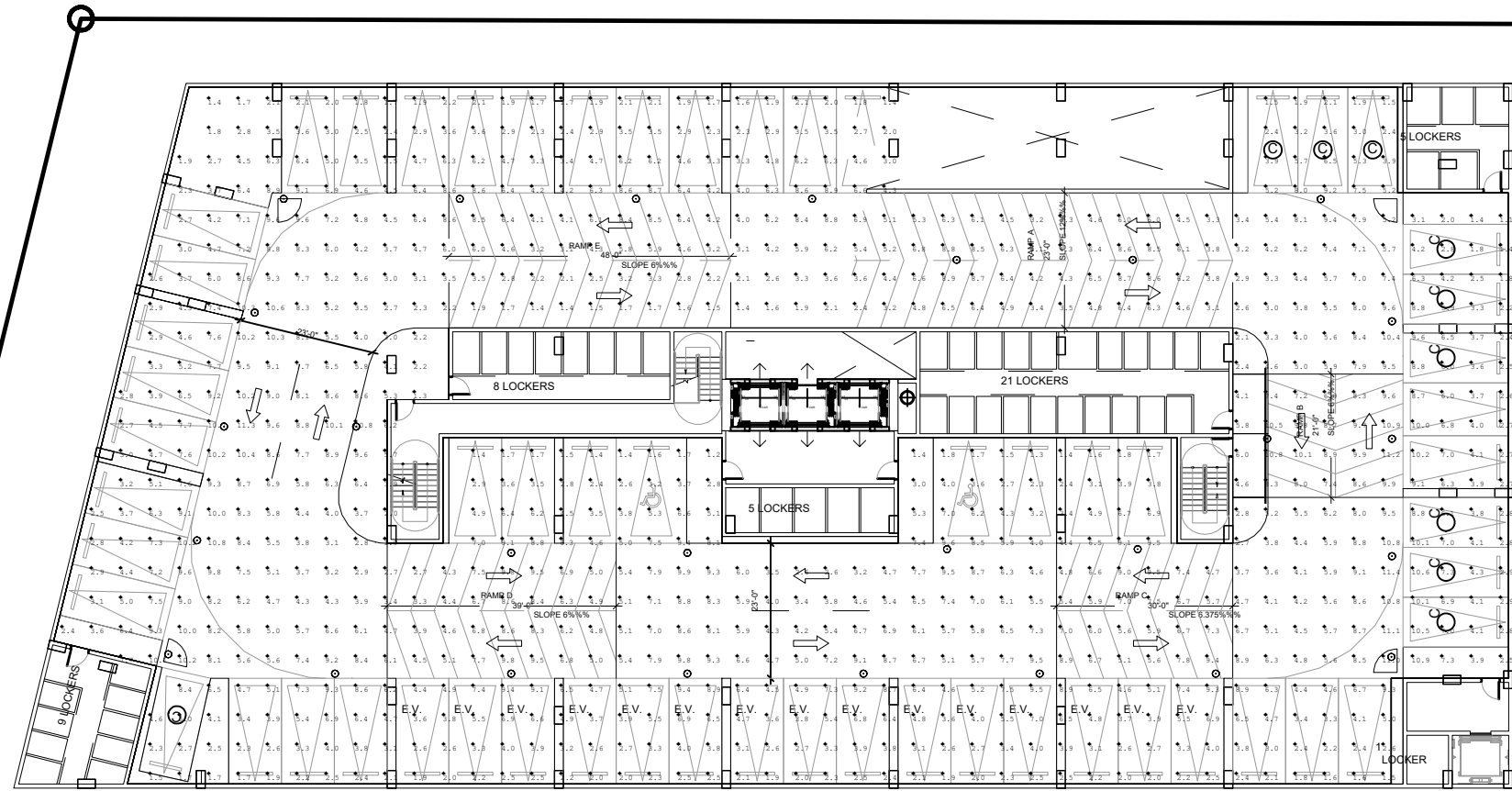
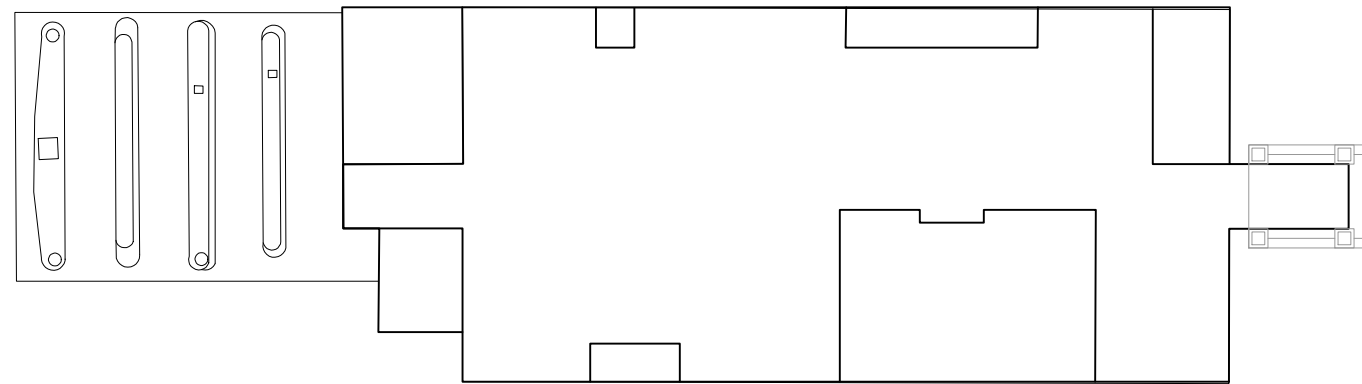
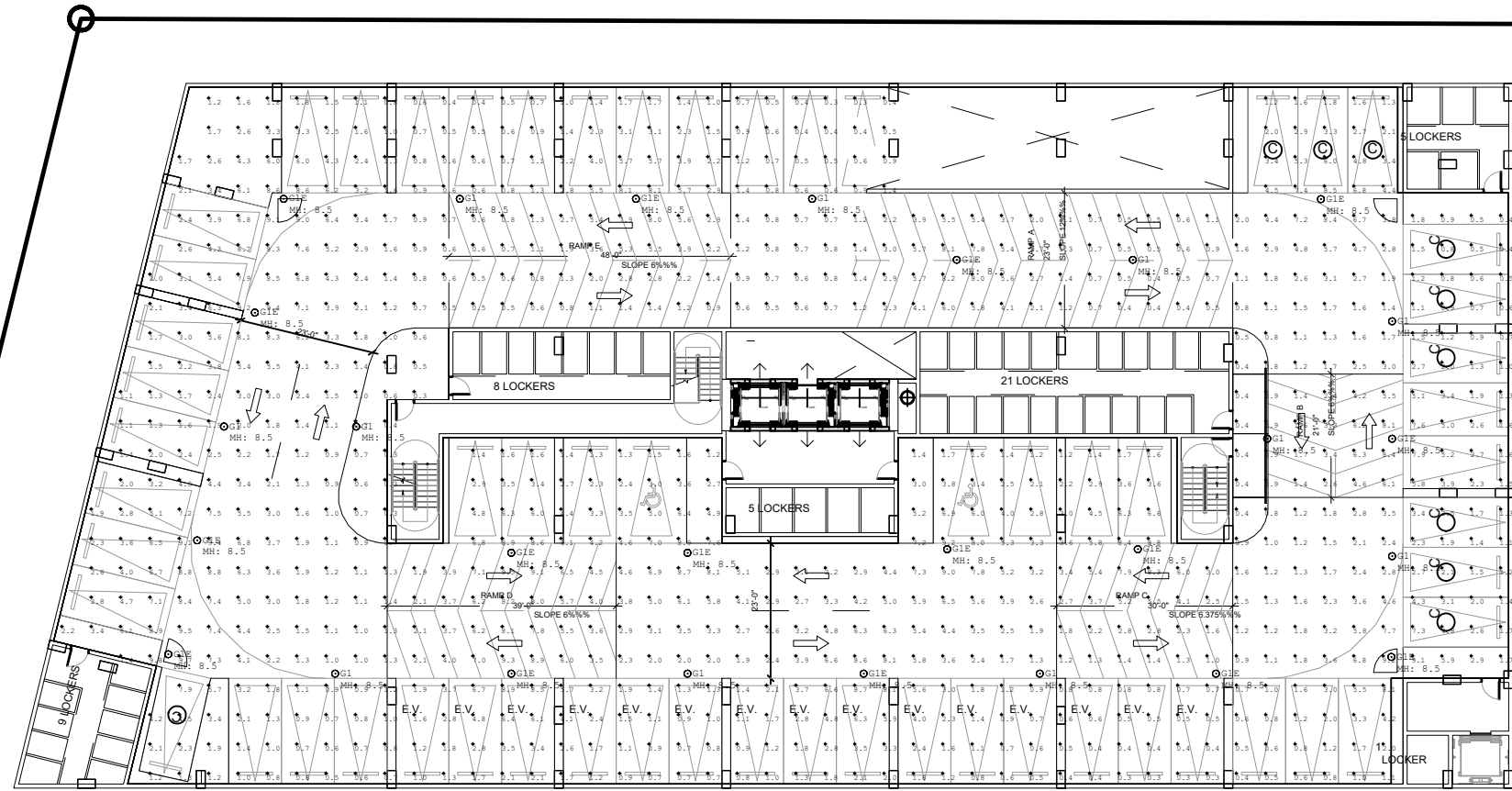

LEVEL 1.5
01
P-002
PHOTOMETRICS - EMERGENCY
SCALE: 1"= 30'-0"

SEAL
TO THE BEST OF MY
KNOWLEDGE, THE PLANS
AND SPECIFICATIONS
COMPLY WITH THE
APPLICABLE MINIMUM
BUILDING CODES AND THE
APPLICABLE FIRE-SAFETY
STANDARDS AS DETERMINED
BY THE LOCAL AUTHORITY IN
ACCORDANCE WITH THIS
SECTION AND 633 FLORIDA
STATUTES.
STEPHANE L'ECUYER
AR 93637

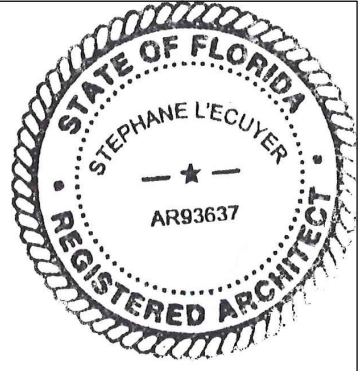

ISSUE FOR:
DRC SUBMITTAL

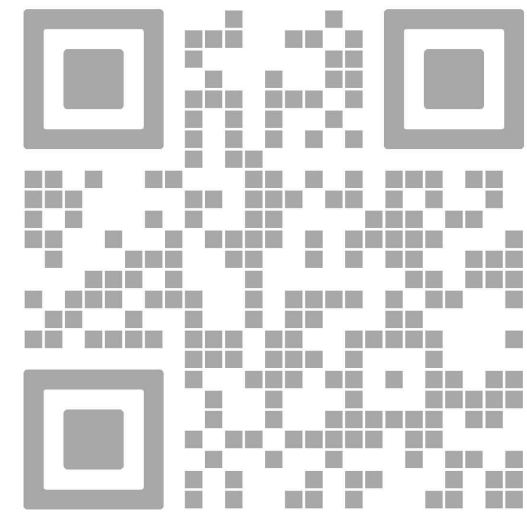

REV.	DATE	DESCRIPTION
01	05-13-2025	D.R.C. SUBMITTAL

ALL MEASUREMENTS MUST BE VERIFIED BEFORE
BEGINNING THE WORKS. NO MEASUREMENTS ARE TO
BE SCALED DIRECTLY FROM THIS DRAWING.

Key section

Client
VERA FUND
NICK POLYUSHKIN
& YURI KHARITONENKOV
TEL: 305.833.3303

Project
**1600 S FEDERAL HIGHWAY
(MIXED-USE PROJECT)**
1600 SOUTH FEDERAL HIGHWAY,
POMPAÑO BEACH, FL 33062

Title LEVEL 1.5 PHOTOMETRICS	
Drawn J. WU	Field ARCHITECTURE
Verified N. TREMBLAY	Scale as shown
Approved S. L'ECUYER	Date 05-28-2025
Project Manager J. WU	Dwg. no. P-002
Project 24-838	